



The View From The Park

A Newsletter of Faith & Community

November 2024

1st Presbyterian Church on the Park
17 Park Street
Canton, NY 13617

Phone (315) 386-2570
www.ChurchOnThePark.org
Office@ChurchOnThePark.org

Sundays in November

- **Worship Begins At 10:00 a.m.** •
- **November 3rd** •

Pledge Sunday
Communion
Deacons & Food Shelf Offering
Where Have You Bean!?! Fundraiser
Daylight Saving Time Ends
(Turn clocks back Saturday night!)



- **November 10th** •

Bring A Friend To Church Sunday



- **November 17th** •

Name Tag Sunday
Noisy Can Offering



- **November 24th** •

Rev. Mike On Vacation
Chris Remick to Preach
Christ The King Sunday
Greening Of The Church



Church Website

Go to www.churchonthepark.org or scan this QR code to see the latest sermon, church calendar, link to our YouTube Channel and much more!



Rev. Michael P. Catanzaro..... Pastor
Pastor Donna Doig, CLP..... Associate Pastor
Andrea Montgomery.....Church School Director
Kathleen Crecco.....Director of Music & Pianist
Christy Dekay.....Office Coordinator
Emily & Kate Ewy.....Nursery Care Providers
Patience Boswell..... Sexton
Aubrey Boswell.....Stream Master
Linda Potter.....Newsletter Editor
Office Hours: 1:30 - 4:30 p.m. Tues. & Thursday

Pledge Sunday

Pledge Sunday will take place on **November 3rd**. In the mail, you should have received an **appeal letter, Stewardship brochure** and your **pledge card**. A pledge card is also on **page 10** and additional cards will be at the church on November 3rd. The Stewardship Committee and Session ask that you **prayerfully consider how our church supports you** and your family, our community, and world, and how you, in turn, **can support the work and mission of our church**.

Contact any member of the Session or Rev. Mike with any questions. Please return the pledge cards as quickly as possible so we may begin to plan **our budget and programs for 2025**.

Thanks to everyone (near and far) for their **continued support** of the First Presbyterian Church on the Park!

Where Have You Bean!?!

A new church fundraiser will take place on **Sunday, November 3rd** from 11 a.m. to 1 p.m. Where Have You Bean!?! is a **food sale** that will feature **homemade baked beans, split pea and ham soup, lentil soup** and other **homemade bean soups**. Pints are \$4.50 and quarts are \$8.

Along with purchasing food, you can volunteer to help with the kitchen prep on Saturday, November 2nd or you can donate your own best bean dish. Contact **Beth Hayes** at hayesbe27@gmail.com or (315) 244-7902.

Family News

Prayers for the family of **Roger McBath** who died in October. A memorial service is planned for Monday, November 11th at 11 a.m. at the Lawrence Funeral home.

Prayers for **Carolyn O'Connor** who was moved to an assisted living facility outside of Boston following Rehab. Here new address is: Residence at Penniman Hill, 276 Whiting Street, Room 216, Hingham, Mass 02043. As of press time we do not have a phone number for her, but will share once determined. Over a great many years Carolyn has been a *champion* card and note writer to so many in our congregation. Now is our opportunity to offer back a bit of kindness to her. Let us shower Carolyn with love and care. Any card or note you care to send, regardless of how well you know Carolyn, would be greatly appreciated.

Prayers for **Anna** and **James Eller** and their new-born **Maryanne**, who are now raising *four* young children (meals appreciated, no tree nuts). Prayers also for **Nicole Potter** and **Chris Melville** now in the second half of their pregnancy (due date February 7, 2025).

Prayers of healing for **Pat Mace** having out-patient surgery on her thyroid in Burlington on Friday November 1st (P.O. Box 11, Canton NY 13617); for **Faye Bartley** recovering from gallbladder surgery at the end of October (9 Church Street, Canton NY 13617); **Wayne Miller** (241 Eddy-Pyrites Rd., Canton) recovering from a broken wrist; **Bill Parker** (17 State Street, Canton) trying to navigate recovery from COVID, rehabilitation from hip-replacement surgery, and caring for **Karen Parker** (17 State Street, Canton NY 13617); **Rich Grayson** slowly recovering from medical challenges (23 CR 33, Madrid NY, 13660).

Continued prayers for **Lew Shepard** and, **Marilyn Coir** in their days; **Rich Denison** who continues to face health concerns,

More Family News

Christa Lyon and **Josh Holbrook** facing health challenges; Janet Favro currently residing at Keene Valley Neighborhood House (Attn Janet Favro, P.O. Box 46, Keene Valley, NY 12943); **Colleen Grant** for healing and wholeness, and husband **Dale** in support of her, (55 Bird Street, Canton, NY 13617); **Alice Poole** facing health challenges (2708 Salem Church Road - Apt. 116, Fredericksburg, VA 22407); **Nick Scelzi**, a resident of the Canton Nursing Home (Willow 206, 205 State Street Road, Canton).

Long distance prayers for Pam Constantine, sister of **Barry Walch**, recently diagnosed with cancer; Dave Pierce, father of **Kristine Potter**, recovering from health issues; Jody Upton, sister of **Susan Akins**; Jeannie Lewis, a former church member who lives in NH and is the daughter of Elsie Dana, being treated for macular degeneration, **Jane Cable's** brother, John Mark, being treated for a reoccurrence of cancer.

Rev. Mike would like to thank the congregation for all the prayers and support for his brother, Paul, who underwent CAR-T Therapy earlier this fall for non-Hodgkins lymphoma. **A recent PET scan has shown Paul to be cancer free!** This is such a new treatment that long-term efficacy is unknown, but certainly a miracle to be celebrated.

**We pray for parents raising children,
and children caring for parents.**

Greening Of The Church

The Greening of the Church will take place after worship on **Sunday, November 24th**. *Many* hands are needed, and an expanded coffee hour is being offered that day to keep us fueled, as together we do the merry work of preparing the church for the Christmas season. **Hope to see you!**



Time For Stewardship

Below are the words that **Patrick LaPierre** recently shared during worship in a "Second for Stewardship". Please consider what the church means to you and the ways you can support it on Pledge Sunday.

Good morning and happy Sunday! Thank you for taking time out of your day to gather at the Church on the Park.

Today is the week before Stewardship Sunday and I hope, in this short address, to focus on what we might contribute in the life of our church.

The LaPierre family arrived in Canton in 2007, kid-less and marinating in free time and general ease. We found our way to the church and were met at our front door, a week later, by Wanda who had a loaf of freshly baked bread. "It's my turn to give you the bread," she told us in that wonderfully straight Wanda way. Apparently, members of the church's welcoming committee took turns door-dashing welcome loaves and Wanda's name was up.

Subsequently, the Lapierre's had two daughters Daphne and Gwen, who have grown up in the church and have had the privilege of concerting with the interesting and loving parishioners here. I imagine many of you have similar stories and of course there are stories to come.

A church is a place where we find our way to God. It is also one of the few places where different generations regularly gather, where great questions are frequently pondered, and a place that offers structure to cope with grief and loss. To find a church like ours that does it so well is a blessing.

As we find ourselves at that time when we come together to show our support for our church by pledging monetary support for the year ahead, consider the physical needs of the church, in which our past

Stewardship - cont.

generosity has enabled repairs to the manse, fountain, and park, funded renovations to the youth rooms downstairs, and a new digital sign outside. But consider too the church as a **curator of memories**. That's a mission too. So, let's be bread givers like Wanda in 2007 – **generous, resolute and unforgettable**.



Time to Fall Back!

Turn your clock back an hour when you go to bed on **Saturday, November 2nd**.

November Lectionary Readings

All Saints' Day - November 1

Isaiah 25:6-9
Psalm 24:1-10
Revelation 21:1-6a
John 11:32-44



November 3

Ruth 1:1-18
Psalm 146
Hebrews 9:11-14
Mark 12:28-34

Sola Gratia

Grace Alone

November 10

Ruth 3:1-5, 4:13-17
Psalm 127
Hebrews 9:24-28
Mark 12:38-44

Sola Fide

Faith Alone

Sola Scriptura

Scripture Alone

November 17

1 Samuel 1:4-20
1 Samuel 2:1-10
Hebrews 10:11-14 (15-18) 19-25
Mark 13:1-8

Christ the King Sunday - November 24

2 Samuel 23:1-7
Psalm 132:1-12 (13-18)
Revelation 1:4b-8
John 18:33-37

Church Attendance

	In-Person	Stream	CS
September 29	27	32	5
October 6	41	45	5
October 13	50	31	No CS
October 22	68	40	6
October 27	70	50	7

Average In-Person Attendance: 51
 Average Live-Stream Attendance: 40
 Average CS Attendance: 6

Treasurer's Report

	Operating	Mission
September 29	\$3,822.00	\$ 415.00
October 6	\$2,286.00	\$ 301.00
October 20	\$9,715.54	\$ 130.00
Total:	\$15,823.54	\$ 846.00

Hospice Lunch & Learn

Hospice of St. Lawrence Valley is offering a Lunch & Learn workshop, **Life Story Project**, on **Thursday, November 14th** from 11:30 a.m. to 1 p.m. Bring a notebook and we will supply **prompts, activities** and **inspiration** to help you remember and capture the **little stories** of the people and events that shaped you, the places you've been along with the love, laughter, and tears you've shared. This workshop was presented last May at our church and those participants are encouraged to attend in November to continue their Life Story Project. Our own **Linda Potter** is a presenter for this workshop.

To reserve your spot for this **free** public event, call Hospice of St. Lawrence Valley at 315-265-3105.

Deacon's Offering

The Deacon's Offering is the **first Sunday** of the month and a vital component of our church's work and mission. Please remember to send along a contribution to the Deacons along with your pledge or regular offering. **Thank you!**

Officers & Committees

Elders On Session

To strengthen and nurture the faith and the life of the congregation.

Joe Montgomery Patrick LaPierre Rob Ewy
 Sarah Melville Barry Walch Jim Franklin
 Anna Eller Heidi Ames Pat McGuire
 Rich Grayson Michelle Theisen
 Patricia Mace - Clerk Of Session

Board of Deacons

Ministering to the sick, those in need, the friendless, and those in distress.

Christy Dekay Ray Erickson Mark Brackett
 Susan Akins Jane Cable Ellen Grayson
 Jean McGuire Bob Duda Stacie Olney-LaPierre
 Secretary Moderator
 Ray Erickson, Treasurer

Committees

Chairs

Resources Jim Franklin
 Responsible for managing and dispensing funds to fulfill the mission & ministry of our church.

Facilities Barry Walch, Rich Grayson & Pat McGuire
 Responsible for the maintenance and use of all church property.

Fellowship Ellen Grayson & Pat Mace
 Responsible for all fellowship events.

Nominating Jean McGuire, Michelle Theisen, Gordy Theisen, Barb Brown & Sarah Melville
 Responsible for filling Session, Deacons & Offices.

Church School Anna Eller
 Responsible for growth, nurturing & learning.

Worship Sarah Melville
 With pastor, responsible for worship.

Communion Pat Mace & Vicki McLain

Stewardship Jim Franklin
 Responsible for securing resources and energy to fulfill the mission & ministry of our church.

Mission Michelle Theisen & Rob Ewy
 Helping our church, community and world.

Treasurer Mary McGreevy

Financial Secretary Barry Walch
 Asst. Financial Secretary Anna Eller

C&C Program JJ Jockel, Sean Boutin & Michelle Theisen

Personnel Anna Eller, Heidi Ames & Patrick LaPierre

The Pastor's Report

Welcome home and welcome to it!

As ghosts and goblins give way to gourds and giblets, Stewardship time is upon us at the Church on the Park.

The first order of business is to offer a **heart-felt thanks to all of you** who have kept us “in business” this past year. Due to your commitment of time, energy, leadership and, yes, financial resources we have moved our church forward for yet another year. It is amazing and humbling to see what a (relatively) small group of people can accomplish toward the ends of bringing goodness, hope, and compassion to the world and our own lives.

And (SNAP!) just like that a *new year* is upon us and it is time once more for us to consider our financial support for our church in 2025. Stewardship letters have already been mailed out (and a pledge card may be found in this month's edition) and this coming Sunday, **November 3rd is Pledge Sunday** when we ask folks to return their pledge of support for the coming year (there are Pledge Boxes in the foyer and sanctuary, or they can be mailed to the church at 17 Park St. Canton, NY 13617).

While it is hard, and in many ways unnecessary, to reinvent the wheel when it comes to the idea and practice of stewardship, I will tell you the nature of the vehicle which rides upon those wheels (i.e., the church) has undergone **significant change** over the span of the past couple of years following the experience of COVID.

It should come as no surprise that many (if not most) churches are struggling with financial viability, membership, and relevance. Thankfully, our church does *not*

number among them. While the size and nature of our physical plant/buildings means we will never have too much, **we always seem to have enough**. This, I have come to realize, is not by accident.

After 32 years in the parish I have arrived at the conclusion that ministry (stewardship included) really comes down to one basic thing: **taking care of people**. Everything else follows from this, or not. While the caring part has not changed much over the course of the past two millennia, the past two years have brought *great* changes

in our understanding of just who, exactly, constitutes the people. Owing to the live-stream, our well-read and utilized newsletter, weekly emailing of the sermon, and the nature of our society, a great many more people may (joyously) lay claim to “belonging” to our church in whatever way each person chooses to understand it. This is simply the

changing nature of church, both as a concept and as an expression. What I believe makes our church unique, is our ability to embrace the grace of this change.

In essence, we have allowed our church to be “customized” for use and participation to the individual resulting in **a sum which is miraculously greater than our ever-diversifying parts**. It follows, then, that each person consider their own unique role is supporting the church in a way which corresponds to the care they receive, how they receive it, and their own distinctive (and/or quirky) sense of belonging to the Church on the Park. **I am absolutely certain that God has big plans for our church, and that each one of us will be part of such a plan unfolding even now.**

We belong to each other! - Rev. Mike

For as in one body we have many members, and the members do not all have the same function, so we, though many, are one body in Christ, and individually members one of another. - Romans 12:4-5

The
Changing
Nature of
Church

Women's Circle

Women's Circle will meet on **Wednesday, November 13th** at **7 p.m.** in Lorna's Lounge with topic of "**Gratitude**". All women of the church are welcome. For more info contact **Linda Potter** at nautilus@twcny.rr.com or 315-229-8886.

Evening Book Group

The Evening Book Group will meet on **Tuesday, November 19th** at 7 p.m. in Lorna's Lounge to discuss **The Frozen River** by Ariel Lawhon with the discussion led by **Linda Potter**. All are welcome.

Volunteers Welcome!

A group of volunteers from our church are assisting the SLC Office for the Aging with their **Home Delivered Meals** program. We are delivering meals on the **second Tuesday** of the month at 35 and 37 Riverside Drive in Canton. Meals are picked up at **10:15 a.m.** and delivered to residents in the two buildings. It takes about **45 minutes** to complete and you are always greeted with a smile.

To volunteer or learn more, contact **Linda Potter** at (315) 229-8886 or nautilus@twcny.rr.com. We hope to increase the number of days per month we can help out.



Holiday Of Lights

On **Friday, November 29th**, families can enjoy a **tree lighting, caroling, wagon rides** and a **visit with Santa**. Our church's Fellowship Hall will once again be the location of the **hot chocolate** and **cookies** served for this Holiday of Lights celebration. **Volunteers are needed** from **5:30 – 7:30 p.m.** to greet families and pass out cookies and hot chocolate. Call or text **Beth Hayes** at (315) 244-7902 if you can help.

Virtual Worship & Fellowship

For live-streaming, fellowship, bulletins, sermons, newsletters, and other resources, **begin by bookmarking the church website:** www.ChurchOnThePark.org. "Click" on the relevant link at the top of the page.

A **live-stream** of the worship service is on the church's YouTube Channel. Go to www.ChurchOnThePark.org and click on "YouTube Channel." You can choose to subscribe to our channel or simply go to this link each week.

Zoom Fellowship calls happen each Sunday (except July & August) from **11:30 a.m. to Noon** for fellowship only with no format or moderator. If needed, download the ZOOM app ahead of time by clicking on this link (free):

<https://zoom.us/download>. Once you have the Zoom app, go to www.ChurchOnThePark.org and click on "Sunday Zoom Meeting". You will be asked to enter a password which is **3862570** (the phone number of the church). The meeting will automatically begin at 11:30 a.m. & end at 12:45 p.m.

Worship bulletins are posted earlier in the week to the church website for those worshipping virtually through the stream on our YouTube channel. This will allow everyone the opportunity to follow the liturgy, and see the announcements and prayer requests. Go to www.ChurchOnThePark.org and click on "Sunday Bulletin."

Written sermons continue to be emailed, or snail-mailed, on *Tuesday* to everyone each week; as well as being posted to the church website. Go to www.ChurchOnThePark.org and click on "Written Sermons."

The monthly **Newsletter** will continue to be emailed to most, and snail-mailed to a few; as well as being posted to the church website (click on "Newsletter").

NOVEMBER Birthdays

- 1 Dave MacMaster
- 2 Tracy Loeffler
- 4 Amanda Eschman,
Duncan Melville
- 5 Judy Longshore
- 6 Mary Grace Gordon
- 8 Rev. Michael Catanzaro,
Laura O'Shaughnessy
- 11 Anne Patterson
- 12 Amelia Rodee, Sarah Rodee
- 18 Wanda Renick
- 21 Janice Poole
- 22 James Eller
- 23 Julia Andes
- 24 Martha Pierce, Betsy Robinson
- 25 David Patterson
- 26 Hunter Montgomery
- 28 Bob Duda
- 29 Stuart Jones
- 30 Olivia Sullivan

Contact the church office with your birthday so we can keep our list current!

Jewish Food Festival

On Sunday, **November 17th** the Beth El Jewish Food Festival will take place from **11 a.m. to 4 p.m.** at 81 Market Street in Potsdam. Breads and pastries from a kosher Montreal Bakery, Beth El prepared blintzes, latkes, falafel, soups, hummus, and lots more to eat in or take out. This is an important (and **very delicious**) fundraiser for their congregation. It is also a tangible (and tasty) opportunity to show support (and to slake one's cravings for carbohydrates).

Hospice Cafe

Join Hospice of St. Lawrence Valley on **Friday, November 15th** from **4 - 6 p.m.** at **Jernabi Coffeehouse** in Potsdam for one-on-one conversations to help you plan and make informed decisions about the **reality of end-of-life care**. The best time to make a plan is **before** serious illness occurs. Grab a coffee and join us.

Giving Tree Time!

It's time again to take a **Giving Tree envelope** and help the Church & Community Program make the holidays brighter for a child in need in our community! Just like last year, we're asking for **donations** to purchase vouchers for **clothing, toys/gifts, and food** for families who need our help, especially at this time of year. With this assistance, parents are now able to shop for their own children and the C&CP has done a terrific job with this method since 2020.



In addition to the three vouchers, each child will also receive a new pair of **PJs** and a hand-knit **hat** made by local knitters. To make this happen, Giving Tree needs your donation by cash, check or online at ccpcanton.org. Giving Tree envelopes are in our church foyer. Thanks in advance for your generosity. If you have any questions, contact our CCP representative, **Sean Boutin, Michelle**

Holiday Farmers' Market

On Saturday, **November 23rd** our church's Fellowship Hall will serve as host site for special holiday edition of the **Canton Farmers' Market**. From **10 a.m. to 1 p.m.** vendors will be selling produce and food products, with GardenShare representatives present to accept SNAP benefits. All are encouraged to stop by and support local farmers, bakers and their families

Election Day

Election Day is **Tuesday, November 5th**. Be part of our democratic system and be sure to vote - whether by early voting, absentee or in-person.



Prayer Warriors

Would you like to help your neighbor, stretch spiritually and be a part of the mystical movement of the church? We are always looking for new prayer warriors to join **the church**

Prayer Chain to offer prayers for folks who are ill, troubled or in need.

If you want to learn more about the prayer chain, call **Rev. Mike** at 386-2570 or **Wanda Renick** at 386-3474.



Photo Directory

Our Photo Directory is no longer available online through the website. If you would like a copy (print or digital), please contact Rev. Mike or the church office and we'd be happy to send one with you. We endeavor to keep the photo directory as up-to-date as possible. If you find that you have been inadvertently omitted, would like to be included or would like a retake, please contact **Rev. Mike**. Updates easily done.

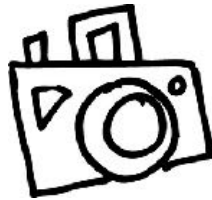

Presbyterian Worship

The next **Partridge Knoll service** is on **November 6th** and will continue through the winter (except January) on the **1st Wednesday** of the month at **11:00 a.m.**



Like Us On Facebook!

The Church On The Park has a **Facebook page** which changes regularly - <https://www.facebook.com/TheFirstPresbyterianChurchonthePark>

New Church Website Live



Christy and Rev. Mike have finished the **NEW Church Website** which is brighter and easier to use. We have switched to a different platform which will allow us to keep the site updated weekly (i.e. calendar)

The Church's email address:

Office@ChurchOnThePark.org

Reverend Mike's email address:

RevMike@ChurchOnThePark.org

Sermons & Services

Written Sermons in PDF format are now available for viewing or downloading on Monday at www.ChurchOnThePark.org then click on "Written Sermons."

If you'd like to have a copy of the weekly sermon emailed or snail-mailed to you directly, please contact RevMike@ChurchOnThePark.Org.

To view recordings of previous worship services, please subscribe to our [YouTube channel](#).

Newsletter Deadline Is The 15th Of The Month

We are still sending out the monthly newsletter! Please submit articles (emailed preferably) to the church office, or directly to the Newsletter Editor, Linda Potter, at:

nautilus@twcny.rr.com

Hello, my name is...

Remember - **Name Tag Sunday** is **November 17th**.

Come early to church and make your own name tag.
Get to know your neighbor.

C&CP Usage

September = 198 HH (we were closed on Labor Day so our total is lower) with **104** children, **202** adults and **133** seniors. Totals **439** individuals. Of the 198, **7** HHs were new to the pantry and **3** were emergency food/homeless people. Compare to: 225 HH last month, and 229 a year ago.

Can You Help?

Volunteers are needed to help staff the **Church & Community Program's Thrift Shop**, at 30 Court St., Canton, during the weekdays of M-F **10 a.m. to 1 p.m.** and **1 p.m. to 4 p.m.** Instruction provided, and initially will work with an experienced person. Join a **friendly** and **helpful** group.

Please call **Connie Jenkins** at (315) 386-3534 if you are interested in volunteering.

Choir & Music News

The Session and our congregation would like to extend **great thanks to Kathleen Crecco** for all of her work with the Choir and her fantastic piano playing. Kathleen will be leaving to pursue other opportunities for herself and her family, with her last Sunday among us being November 24th. We have surely appreciated her efforts, and wish her all the best in the future.

A search is currently underway for a new Pianist and Choir Director. Folks with such skills and availability are hard to find these days, so please spread the word with any people with musicality you may know. We are going to need another miracle. **Bob Duda has graciously agreed to play piano** for worship during Advent, and for this we are profoundly grateful. Moving forward, **Choir members will be robing and siting in Choir Loft** to help lead singing in worship on Sunday mornings (about which Rev. Mike is thrilled).

Farm Family Offering

Our Farm Family Offering is an opportunity for you to share your **mission dollars** with **local farmers**. Because of this mission program, which we began in 2002, many farm families have been able to buy presents for their children when they wondered where the money would come from to do so.

Our local producers have to deal with **whatever weather** that Mother Nature sends - sun, rain sleet, dry or soggy fields, warm or freezing temperatures. Today's economy is not easy. Cost of production may be higher than the payment they receive for their product. Despite these challenges, our local farmers will do their best to provide their **foods** and **products** to us.



During the month of December, **monetary gifts** will be delivered personally to **local farm families** producing meat, milk, fruit, vegetables, syrup, honey, or nursery plants. Together our dollars will provide a Merrier Christmas for farm children and their parents.

Bring your donation to church on **Sunday, December 1st** where there will be envelopes addressed to **"Farm Family Offering"** in which you can insert your money. For church families who receive a snail-mailed newsletter, an envelope will be attached. You can also mail your donation (check only-no cash) to: Canton Presbyterian Church, 17 Park Street. Be sure to note for **Farm Families** on check. **Thank you for making a difference!**

Marilyn Rodee
Farm Family Coordinator

**The Church Office
will be closed on
November 12 & 19.**

Pledge Sunday Is November 3rd

The chart below is part of the stewardship brochure which was in the mailing which you received. It shows the number of **pledging units** along with **average** pledge amount. Only you (and your family) know what amount is best for you. Together, we are the stewards of this church, giving our **time, talent** and **treasure** to make the Church On The Park a vital, welcoming part of our community. Consider what it means to you and bring or mail your pledge to the church on **Pledge Sunday, November 3rd**.

Pledges 2020-2024

Amount Pledged	# Of Pledging Units				
	2020	2021	2022	2023	2024
\$0 - \$399	3	2	2	4	2
\$400 - \$999	9	10	6	6	8
\$1,000-\$1,599	12	16	12	10	11
\$1,600-\$2,499	11	11	9	14	14
\$2,500-\$3,999	12	12	11	11	11
\$4,000 and up	<u>4</u>	<u>4</u>	<u>8</u>	<u>8</u>	<u>9</u>
Total:	51	54	48	53	55
Average Pledge	\$1,934	\$2,026	\$2,386	\$2,117	\$2,078
Weekly	\$37.20	\$38.97	\$45.88	\$40.72	\$39.87
Membership	105	105	95	110	103
Total		\$109,429		\$112,230	
	\$98,670		\$105,971		\$114,328

My Estimate of Giving

Yes! I would like to help support the work of our Church. During the coming year, I plan to give \$_____ per week, to be divided as follows:
 \$_____ for our church and \$_____ for General Mission.

_____ **Yes, I would like offering envelopes.**

Name: _____

Address: _____

Email: _____

Please bring to the church on November 3rd or mail to 17 Park Street, Canton NY 13617.

Your support of our church is greatly appreciated! Thank you!

A reminder of My Church Pledge:

During the coming year, I plan to give to our church \$_____ per week.

Brick Chapel Update

This brick church built in **1815**, located 4 miles outside of Canton on County Route 27 in God's country, is listed in the National Historical Society.

There are a few members who attend services during July and August, but all members have been canvassed and do not want to see the church closed. It has been difficult to fund payments for minister and keyboard player for those months. The Ladies Aid Society meets first Thursday of every warm month. The Society pays electric and security light bills. Due to the mature age of remaining members, no money raising events have been held!

During 2023, a local group of people in the community needed a meeting place and the church was located right in the middle of this community, so it was agreed to let these folks hold monthly Saturday night potluck dinners and conversation. They met in the church until cold weather dictated closure of the church until spring. Elliott and Mary Rodee opened Saphead Event Center for monthly potlucks. This group is very supportive of community and monetary donations were designated to pay for church expenses. Elliott and Mary hand-delivered meeting notices which brought over 40 locals coming with delicious food and many donated dollars for expenses. Winter arrived and slowed attendance.

2024 has brought exciting news for Brick Chapel. Three new younger people wanted to be members and have joined the church-Peggy (Bullis) Shea, Mark Shepard and Mary Rodee. Donations earmarked for the church have been received in memory of Lawrence Aldous. A young man who grew up in Brick Chapel, attended church with Jan and Roger Favro has a strong attachment for his community, sent a \$1,000 check to

Brick Chapel - cont.

assist with expenses. A neighbor Masonic member, secured a \$500 donation. A bid is out for repairs of the steeple, wooden window and door casings need paint and there are rumbles about replacing the dining room floor! There are sounds of revival for this old church and enthusiasm to make it happen. May our Lord look favorably on our efforts. - **Marilyn Rodee**

Food Pantry Donations

Suggested **donations** for the food pantry at C&CP include: Potatoes, Apples, Oatmeal, Cereal, Granola Bars, Crackers, Canned Soup, Peanut Butter, Pasta, Spaghetti Sauce, Tuna, Mayonnaise, Baked Beans, Canned Beans, Canned Fruit, Canned Vegetables. Thank you!

Saving Grace

We're given seeds upon this earth
to plant and sow the ground;
And with the sun and gentle rain
in due time will abound.

In summer time the heads will fruit,
the stems will touch the sky;
And in the autumn time of year,
we'll reap the wheat and rye.

So as we reap what we have sown,
may words of thanks impart;
Our gratitude, like fruitful seeds,
Spring always from our heart.

- Philip Kapusta

Share Your News!

Shout out and share the word about your kids and grandkids with your church family! Tell us about their involvement with **sports, music, theater** as well as **academic achievements** and anything else that you to shout out!



Send in your news to the church office (315) 386-2570 or office@ChurchOnThePark.org

Also, let Rev. Mike know when the kids have a game, recital, performance or award ceremony. Text him at (716) 857-0111 or email him at RevMike@churchonthepark.org.

OFA Holiday Gift Drive

The **Office for the Aging** is sponsoring the **11th Annual Holiday Gift Drive** for older adults in SLC. They are collecting financial contributions to purchase gift cards and/or gift baskets for older adults in their home-delivered meal program. Mail your contribution by **December 6th** to Office for the Aging, 80 State Highway 310, Suite 7, Canton NY 13617. **Thank you!**

Kids' Christmas Pageant

The Annual Christmas Pageant will take place during worship on Sunday, **December 8th**. With no church school on December 1st (due to the Thanksgiving break), there will be a lot of planning in a short time to pull this off! Parents - mark your calendars! To learn more, contact our Christian Ed. director, **Andrea Montgomery** at amq20@yahoo.com.



Session Report

Session met on **October 7th**. Rev. Mike reported that a **new grill** has been purchased from a \$1,000 donation from the family of **William Webb**. The "Grill Team" will consist of **Jim Franklin, Rob Ewy** and **Joe Montgomery**. A blessing of the new grill will be held at a future date. Hot dogs and hamburgers will be served that day at coffee hour.

The **cabinets** for the **nursery** have been delivered and will be installed later this month. Christian Ed. is going well. **Jim Franklin** and **Patrick LaPierre** will co-chair the Stewardship Committee.

Barry Walch will make additions to the piping for the **drainage system** for a better appearance and he will install a diverter to keep the rain from falling against the outside wall next to the choir room. The cabbage roll dinner made **\$1,150** and the fall rummage sale raised **\$2,271.52**.

It was voted and approved to renew and continue **Pastor Donna Doig's** Terms of Call. A discussion was held regarding the pianist's and music director's position(s) with a decision reached to begin a search.

Again this year, an **anonymous donation** has been made to the church with the restriction that it be used in the community. So far, **\$3,800** has been given from that donation to the Bear Pack program at the school. and **\$3,000** worth of local ground beef has been purchased for the CCP food pantry.



Michelle Theisen reported CCP was very happy for our donation from selling tickets. Noisy Can fund has raised \$150 which will be used to purchase food for the food pantry.

Next Session meeting is October 28th.

SIGN(S) OF THE TIMES

Thank You
Canton Garden Club
Members Past and Present
For a Century
of Service and Beauty

Worship & Church School
Begin at 10:00 a.m.
Sunday's sermon In-Person and On-line
Nursery Care Provided
"Mercy On The Way"
www.ChurchOnThePark.org
OCT 24 1:57 PM 44° 315.386.2570

Don't surround yourself
with yourself.
Take a straight
and stronger course
to the corner of your life.
- Jon Anderson of YES

**Forgiveness
Is The Key
To Every Door**
- Phil Lesh, Box Of Rain

**Everything
Looks Worse
in Black and White**
- Paul Simon

**Happy
Halloween!**
Trick or Treat, Bags of Sweets,
Kids Are Haunting All The Streets

"Voting is the expression
of our commitment
to ourselves,
one another, this country,
and this world."
- Sharon Salzberg

**Where You Bean!?!
Fundraiser**
A Variety Of Bean Soups
For Sale As Take-Out
This Sunday 11 a.m. to 1 p.m.

Photos From Our Fall Bazaar!



Thanks to
EVERYONE
who helped
and made this
such a fun and
successful
event for our
church!!!





**Beyond the good time
which was had by all,
we raised \$1,987
for our church!!**



Happy Halloween!!!



Thanks to all those (young *and* old) who came to worship in costume the Sunday before Halloween. Here on the Park we avail ourselves of every opportunity to celebrate.



Noisy Can! To Support C&CP



Michelle Theisen and **Christy Dekay** took **Aubrey Boswell**, **Rosalie Dekay** and **Sebastian Dekay** shopping at Walmart with \$150 raised from Noisy Can to make purchases for the Church & Community Program's food pantry. They were able to purchase: 14 cans of soup, 13 jars of pasta sauce, 24 cans of Beefaroni & Ravioli, 12 cans of vegetables and baked beans, 8 large boxes of instant oatmeal (160 individual packets), 2 large boxes of hot chocolate (60 individual packets) and nine 5 lb. bags of potatoes.

Connie Jenkins, CCP Director, sends a big thank you to the youth of our church and the generous donors of this important mission. Each month, CCP assists over 200 households, helping to feed adults, children and the elderly and working to meet emergency needs.

The Bill Webb-er Grill



Great thanks **the family of Bill Webb** who provided our church with a new Webber grill from memorial gifts given in his memory.

Members of the newly formed **“Grill Team”** have plans for a **Winter BBQ** to inaugurate.

Nursery Remodel Nears Completion!

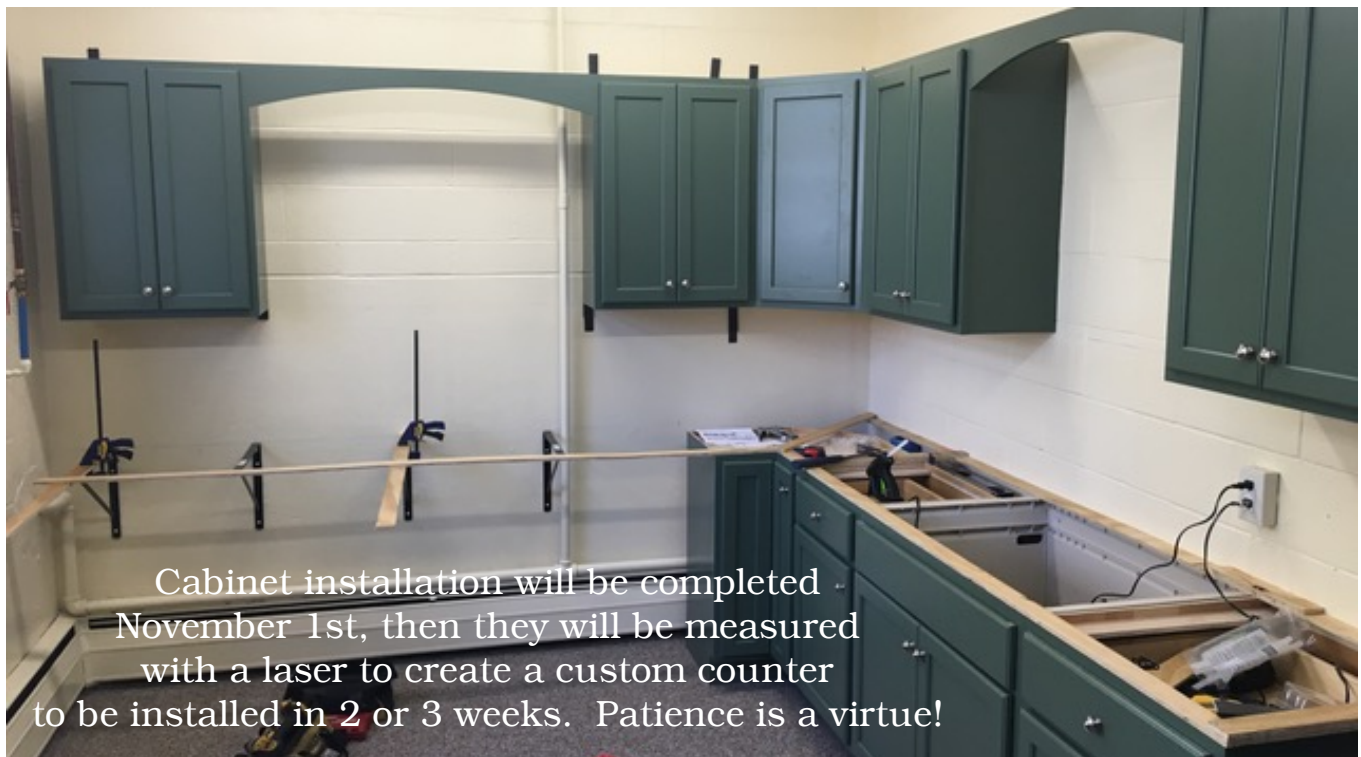

November 2024

Sunday	Monday	Tuesday	Wednesday	Thursday	Friday	Saturday
27 Costume Sunday Stewardship Sermon 11:15AM Church Fellowship Zoom Meeting	28 7:00PM Session	29 1:30PM Church Office Open	30	31 Halloween 1:30PM Church Office Open	1	2 DST End @ 2 a.m.
3 Communion Deacon & Food Offering Pledge Sunday 11:00AM Bean Fundraiser 11:15AM Church Fellowship Zoom Meeting	4	5 Election Day 1:30PM Church Office Open	6 11:00AM PK Service	7 1:30PM Church Office Open	8	9
10 Bring A Friend To Church 11:15AM Church Fellowship Zoom Meeting	11 Veteran's Day	12 10:15AM HDM @ Riverside Apts 1:30PM Church Office Closed	13 7:00PM Women's Circle	14 1:30PM Church Office Open 4:15PM C&CP Board Meeting	15 Newsletter Deadline	16
17 Name Tag Sunday Noisy Can Offering 11:00AM Jewish Food Festival 11:15AM Church Fellowship Zoom Meeting	18 Rev. Mike On Vacation	19 1:30PM Church Office Closed 7:00PM Evening Book Group	20	21 1:30PM Church Office Open	22	23 10:00AM Holiday Farmer's Market (FH)
24 Rev. Mike On Vacation Chris Remick To Preach Greening of the Church 11:15AM Church Fellowship Zoom Meeting	25 7:00PM Session	26 1:30PM Church Office Open	27	28 Thanksgiving	29 6:00PM Holiday of Lights	30